

VISTA SUPERIORE GRIGLIE

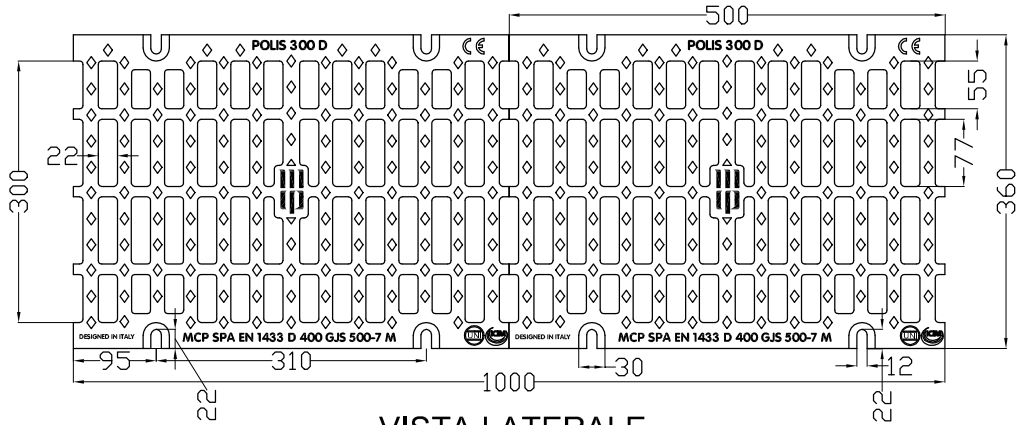

VISTA LATERALE

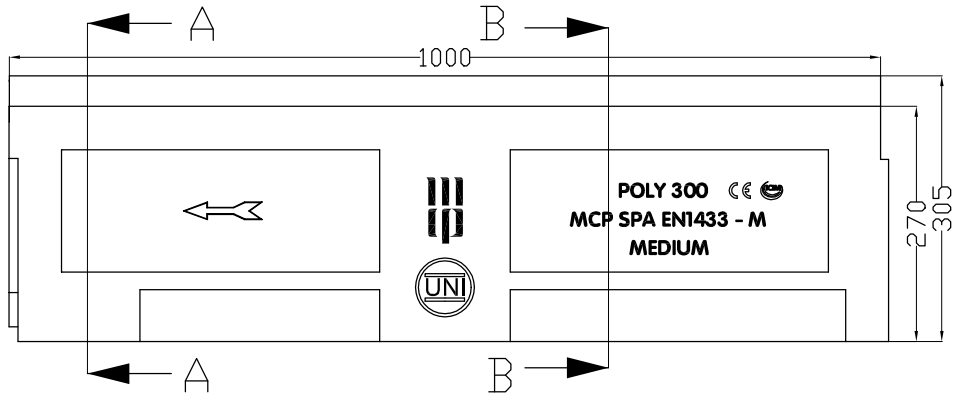

VISTA INFERIORE

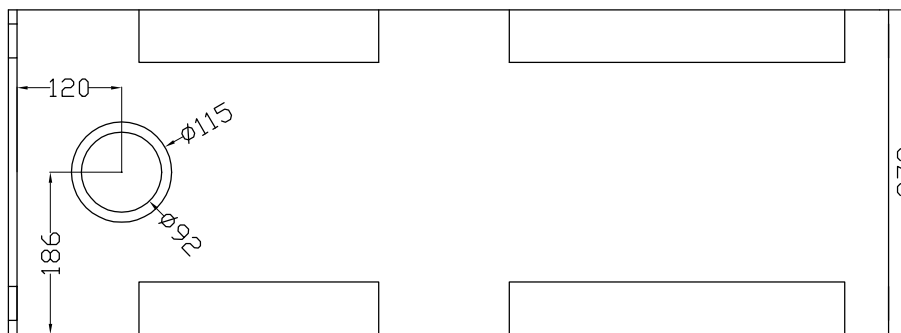

VISTA FRONTALE

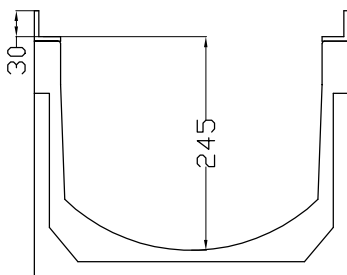

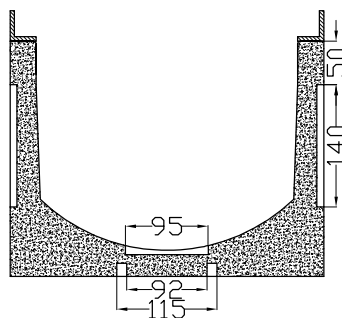

SEZIONE A-A

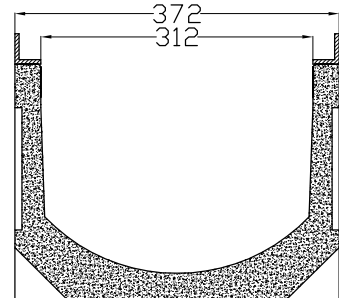

SEZIONE B-B



 Mario Cirino Pomicino s.p.a. La garanzia del risultato 	CODICE CODE	POLIS 300D-M	MATERIALE MATERIAL	GJS500-7 POLYMERIC CONCRETE	NUMERO CERTIFICATO 003BF CERTIFICATE NUMBER
	SERIE SERIES	POLIS	CLASSE CLASS	D400	
	DIM. ESTERNE EXTERNAL DIM.	mm 1000x372			
	LUCE NETTA CLEAR OPENING	mm 312			
	ALTEZZA TOTALE TOTAL HEIGHT	mm 305	PESO TOTALE TOTAL WEIGHT	Kg. 100.3	

UFFICIO RICERCA E SVILUPPO
OFFICE RESEARCH & DEVELOPMENT

La proprietà di questo documento è della Mario Cirino Pomicino SpA. L'uso del disegno e delle informazioni contenute sono riservate e la eventuale trasmissione a terzi deve essere espressamente autorizzata dalla Mario Cirino Pomicino SpA per iscritto. Ogni violazione sarà perseguita nei termini di legge. E' fatta riserva di tutti i diritti derivanti da brevetti e modelli. The present document is property of Mario Cirino Pomicino SpA. The use of drawings and information contained are confidential and reserved. The eventual transmission of the same to a third party must be authorized by Mario Cirino Pomicino SpA in written. Violators will be prosecuted in accordance with law. Other rights on patents and models remain reserved.

VIA CAMPO DEI FIORI, 11 - 80025 CASANDRINO (NA) - ITALIA - TEL. 081/7106008 - FAX 081/5733077 - EMAIL info@mcponicino.com - www.mcponicino.it